



MANUAL

PET PROOF MOTION DETECTOR

ACCESSORY HOME+ ALARM SYSTEM

AS90PP

Home is not a place, it's a feeling

Inhoud

1. Introduction	- 2 -
2. Pairing with the app	- 2 -
3. Switches A and B	- 2 -
4. Testing the motion detector	- 3 -
5. Changing batteries	- 3 -
6. Technische gegevens	- 4 -
7. DoC.....	- 4 -
8. Explanation of symbols	- 4 -

1. Introduction

The motion detector accurately detects temperature differences due to movement within the detection area (1). You use a motion detector to monitor a room. Pets up to 20kg are not detected. Movements perpendicular to the detection area are most effective (2). Automatic temperature compensation ensures stable operation. You get a push message when the battery voltage is too low.

2. Pairing with the app

The batteries must be activated, remove the plastic strip (3). The motion detector starts a self-test during which the red LED (4) flashes for 30 seconds. You can use the TEST button on the back to check whether the motion detector works when the alarm is switched on.

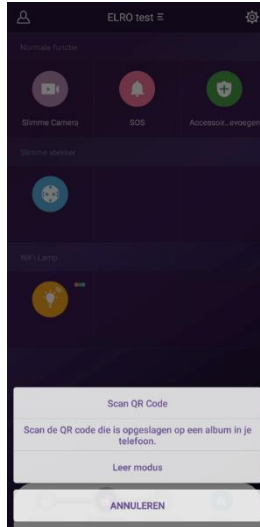
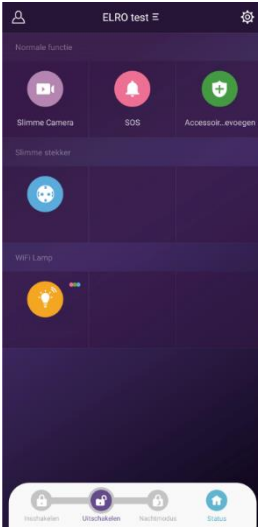

Open the app on your smartphone, tap "Add accessories" and select the "Scan QR code" option. Scan the QR code on the product and give it a (location) name. Finally, tap the blue "V" to set up the transmitter.

3. Switches A and B

These switches are factory set as follows:

- **Switch A (= ON)**
Allows you to switch the motion detector on and off. Change the position of **Switch A** only if you do not use the motion detector for a period. If this is a period of several months or even longer, we recommend removing the batteries.
- **Switch B (= 5 seconds).**
The 5-second position is the test position (function test). The 5-minute position is the position for daily use. Change the position of **Switch B** after testing the motion detector.

4. Testing the motion detector

Testing a motion detector means checking the room for dead spots, i.e. where the motion detector has no perception. There are 2 executive options:

1. Via the app, set the base unit's siren to "silent". After each detected movement, the window of the motion detector, a red LED lights up briefly and you get a push message in the app.
2. Holding the remote AS90RE in your hand. After each detected movement, the alarm goes off, turn off the alarm (each time) with the remote control and you get a push message in the app.

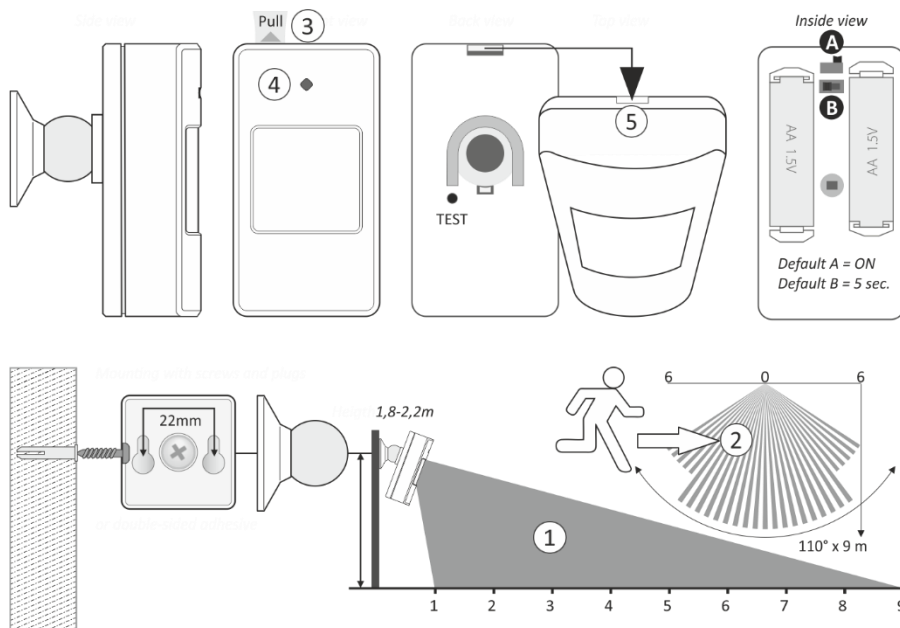

Summary

- If you test the motion detector, then it should be in test mode (switch B = 5 seconds).
- If the motion detector seems to be working properly then the switch should be in normal mode (switch B = 5 minutes). Carefully open the housing (5) and set the switch to the "5 minutes mode".

Note:

If an intruder enters your home, then this person will be detected immediately resulting in an alarm notification. After this, it takes 5 minutes before another detection takes place. This function prevents the motion detector from detecting continuously, resulting in quick battery drain.

5. Changing batteries

Carefully open the housing (5) of the motion detector and replace the 2 "AA 1.5V" batteries for new ones. Do not use rechargeable or used batteries.

6. Technische gegevens

Operating voltage	DC 3V
Batteries	2 x AA 1,5 V
Operating current	≤40mA
Standby current	≤0,2uA
Frequency	433.92MHz
Detection range	110°
Detection distance	9m
Immunity pets weight	20kg
Transmission range	Up to 150m (without obstacle)
Temperature	-10°C ~ 50°C
Humidity	90%rh (non-condensing)
Weight	67g (battery not included) 62g (bracket) 114g (battery included)
Dimensions	99 x 53 x 36mm

7. DoC

I, ELRO Europe, hereby declare that the radio equipment type AS90KEA complies with Directive 2014/53/EU. The full text of the EU declaration of conformity can be found at the following internet address: www.elro.eu/compliance

- Frequency: 433.9MHz
- Maximum transmit power: -1.223dBm

ELRO Europe | www.elro.eu
Postbus 9607 - Box E800
1006 GC Amsterdam - Netherlands



8. Explanation of symbols



Recycling and disposal: The WEEE symbol means that this product and batteries should be disposed of separately from household waste. When this product has reached the end of its service life, take it to a designated collection point near you for safe disposal or recycling. Protect the environment and human health, use natural resources responsibly!



Read the manual before use and keep it for future use and maintenance.



Warranty visit www.elro.eu